

How to Travel Within Kyoto

Contents

- 1 Using Kyoto Station
- 2 Useful Tourist Information
- 3 How to Ride Trains and Buses
- 4 Returning to Kansai International Airport

1. Using Kyoto Station

The following maps show where to board take trains and buses, as well as locations of coin lockers, ATMs, and currency exchange offices.



※ Characters **a**–**f** indicate escalators and stairs, and numbers **1**–**3** indicate elevators which leads to other floors.

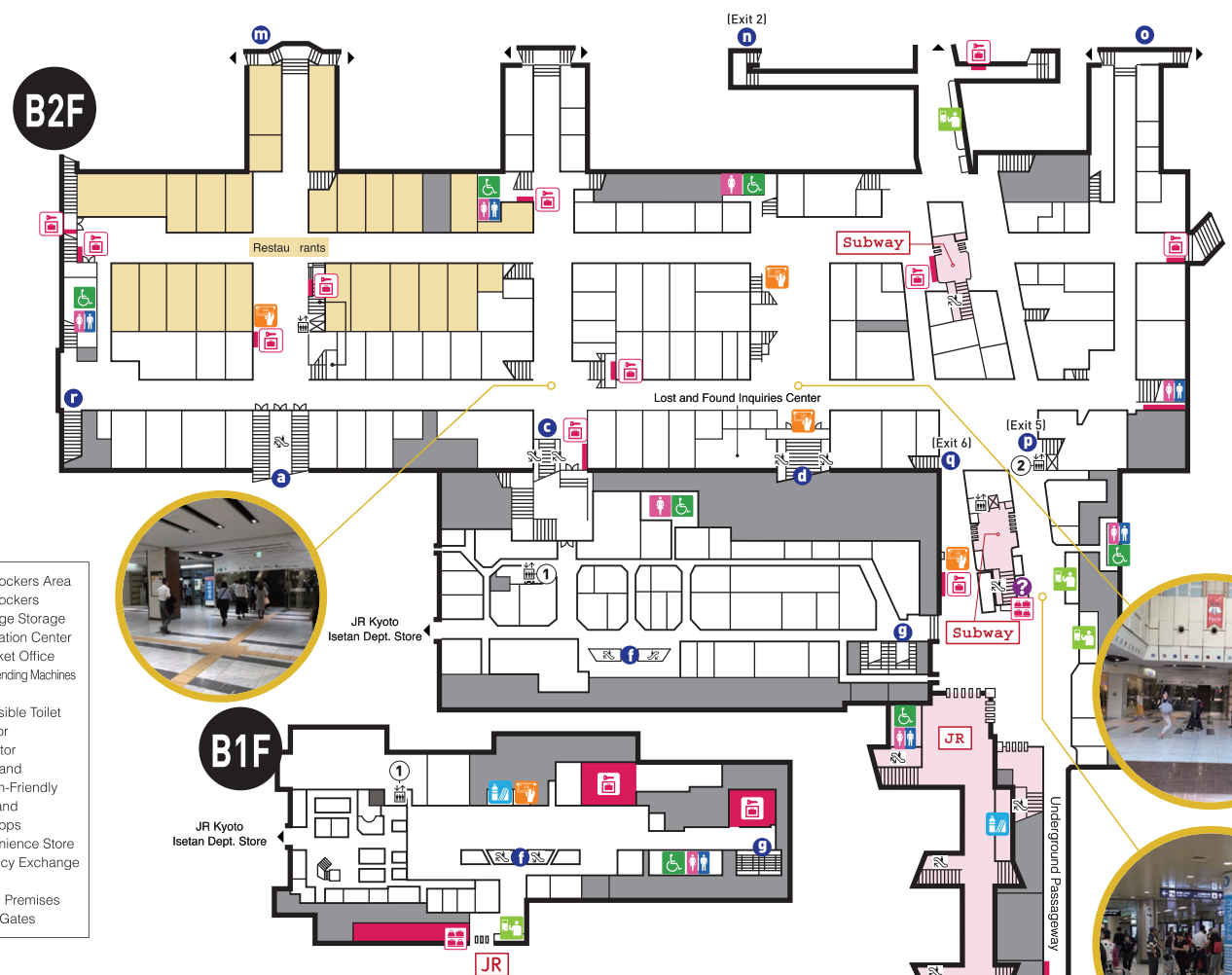
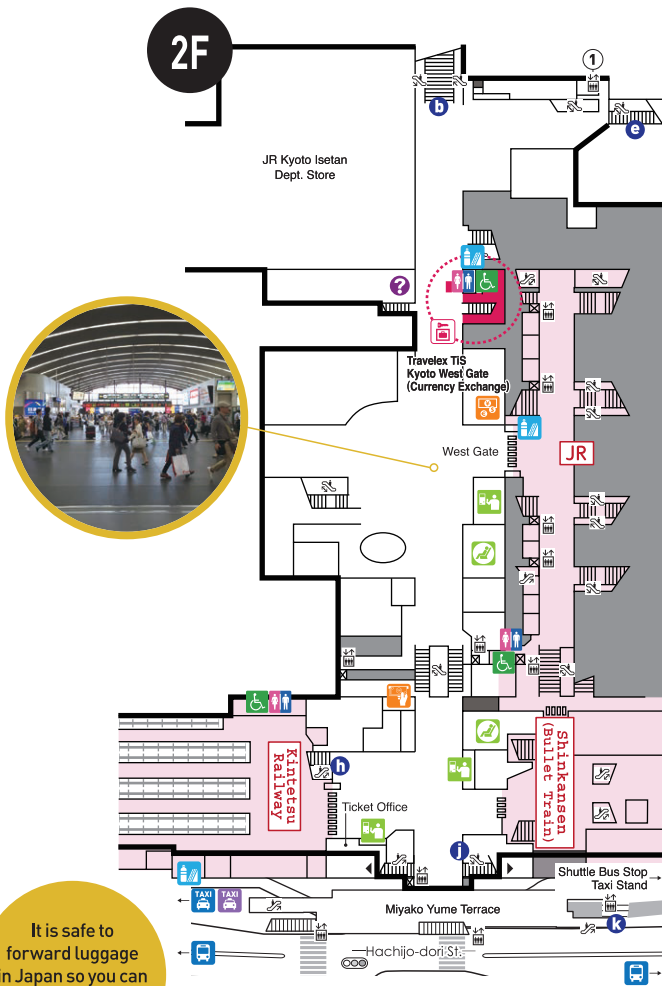

Legend:

- Coin Lockers Area
- Coin Lockers
- Luggage Storage
- Information Center
- JR Ticket Office
- Ticket Vending Machines
- Toilet
- Accessible Toilet
- Elevator
- Escalator
- Taxi Stand
- Foreign-Friendly taxi stand
- Bus Stops
- Convenience Store
- Currency Exchange
- ATM
- Station Premises
- Ticket Gates

It is safe to forward luggage in Japan so you can travel light to enjoy your trip.

Sightseeing Tip 1 Useful Information on Forwarding Luggage

- are offices that offer a luggage delivery service to your hotel (applications for that day close around noon.)
- Leave your luggage at a "Hands-Free Travel" counter and it will be delivered to your hotel by the end of the day. (Certain exceptions apply.)
- In many cases, an additional charge for coin lockers will apply at midnight.
- You can lock coin lockers only once. If you reopen the closed locker, further charges will apply.

Sightseeing Tip 2 Sightseeing in Kyoto

- Kyoto has many hidden tourist spots in addition to well-known ones.
- Most temples and shrines will close early in the evening except during nighttime illumination periods.
- If you smoke on the street, a ¥1,000 penalty will be imposed.
- Taking photos on railway tracks is very dangerous.



2. Useful Tourist Information



How to Travel to Popular Tourist Sites

With the Arukumachi Kyoto Route Planner App “Bus and Train Veteran,” you can easily find appropriate routes. This is an official app of Kyoto City, so you can rest assured using the service.



iPhone users



Android users

Check the location of bus stops, bus routes and present location of buses

In Kyoto, IC cards (transport smartcards) can be used on buses and trains.

There are 10 different IC cards you can use in Kyoto.



* Card designs are subject to change at the discretion of IC card issuers.

Cycling Rules and Etiquette

Make your cycling more enjoyable!

Five Rules for Safe Bicycle Riding

- ① Bicycle riders must in principle ride on the road, using sidewalks only in exceptional circumstances.
- ② Bicycle riders must ride on the left side of the road.
- ③ When riding on sidewalks, bicycle riders must ride slowly on the side closest to the road and yield to pedestrians.
- ④ Bicycle riders must obey all safety rules.
- ⑤ Children on bicycles must wear helmets.

Rules on Illegally Parked Bicycles and Parking that causes Trouble

- Bicycle parking in the street is prohibited in Kyoto City.
- Bicycles parked on a street will be subject to immediate removal.
- The bicycle owner (or renter) must pay 2,300 yen to have it returned.

* Park your bicycle in a designated bicycle parking lot.

● For more information on cycling (bicycle parking lots, rental services, and bicycling rules) in Kyoto City, please visit the following website: Kyoto City Cycling website <https://kyoto-bicycle.com/foreigners>

3. How to Ride Trains and Buses

TRAIN

1 Buy a ticket from a ticket vending machine.

- In many cases, English language display can be selected.
- Confirm the fares with the Arukumachi Kyoto Route Planner App or the fare map displayed above the machine beforehand (Children aged 6 to 11 will be charged half the adult fare).
- If you have any issues, press the "Call" button to speak to the staff.



2 Pass through the ticket gate with a ticket or smart card.

3 Go to the platform and board the train.

4 Get off the train and exit the ticket gate.

For details, browse:



* Note that the only "subway" in Kyoto is the City Subway, although other trains run underground.

BUS

1 Board through the rear door.

- If device A or B is near the entrance door, take a numbered ticket, or, if using a smart card, tap the card on the reader.

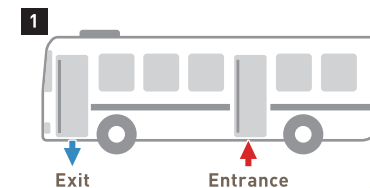

2 Press the stop button if getting off at the next stop.

3 When the bus stops at the bus stop, pay the fare and get off.

※No change is given, so prepare the exact amount beforehand.

- If you use a one-day pass (valid only for specific routes and areas):
- ① Insert the pass into the device when you first get on the bus.
 - ② From the second time, show the date printed on the pass to the driver when you get off.

For details, browse:



* Buses on some routes require you to enter through the front door and to exit through the rear door.



Sightseeing Tip 3 Notes on travel smart cards

- Travel smart cards (Kansai One Pass, etc.) sold at Kansai International Airport, Kyoto Station, etc. can be used in many trains and buses in Japan. Smart cards save the trouble of buying tickets, making your trip smoother.
- Please note that, in many cases, refunds are available only at the place of purchase.
- Cards can be recharged using recharging machines or some ticket vending machines near the ticket gates.

Sightseeing Tip 4 Discount Tickets / Passes

- The Subway & Bus One-Day Pass, which costs only 900 yen, could benefit you since with this pass, you can ride the Kyoto City Subway (all routes), City Bus (all routes), Kyoto Bus (excluding certain routes), and Keihan Bus (excluding certain routes) lines as many times as you want for the duration of one day. By using both buses and subway, you can greatly reduce your travel time and move around the city more efficiently. Major tourist spots in the area: See 4~18 on page 8.
- Various discount tickets/passes are available.

4. Returning to Kansai International Airport

Below are the major routes from Kyoto to Kansai International Airport (KIX). Note that KIX and Osaka International Airport (ITM) are two different airports.

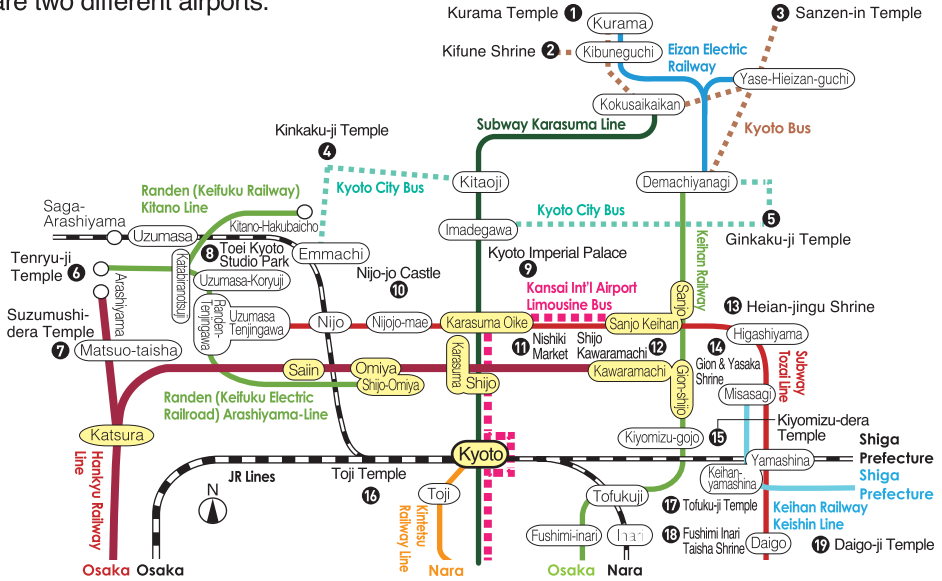

Hankyu Railway

KANKU ACCESS TICKET

First, go to Awaji Station, and then transfer to a train bound for Tengachaya. At Tengachaya Station, take a Nankai Railway train bound for Kansai Airport.

Fare 1,230 yen

Approximate time required

1 hr 50 min

Available at

Hankyu Kawaramachi Sta.,
Karasuma Sta., Katsura Sta.,
and other major stations

JR West

Kansai-Airport Express HARUKA or Conventional Line Rapid

- **Kansai-Airport Express HARUKA**
...Direct access from Kyoto Station

Fare 1,880 yen

Limited Express surcharge (non-reserved seat)

970 yen / Total 2,850 yen

Approximate time required

1 hr 20 min

Available at

JR ticket offices and from
green-colored ticket vending machines

- **Conventional Line: first, go to
Osaka Station, and then transfer
to the Kansai Airport Rapid.**

Fare 1,880 yen

Approximate time required

1 hr 50 min

Available from

Ticket vending machines

Keihan Bus

Kansai Int'l Airport Limousine Bus

Directly access to KIX

The bus can be boarded at Kyoto Sta. (Hachijo Entrance), Sanjo Keihan, Kyoto City Hall, Karasuma Oike, Shijo Karasuma, Horikawa Gojo, etc. (*)

Fare 2,550 yen

Approximate time required

1 hr 30 min (from Kyoto Sta.)

Available at

Kyoto Sta. Hachijo Entrance
Information Center (in front of the
bus terminal)

※The bus can also be boarded at
Demachianagi Sta., Nijo Sta., and
Shijo Omiya (regarding some
morning services).